

# FBO Series

# FUEL

## Specifications:

**Height:** FBO-10 19.0" (48.26 cm)  
with DP Gauge 20.08" (51.0 cm)

FBO-14 23.0" (58.42 cm)  
with DP Gauge 24.08" (61.16 cm)

**Width:** 8.6" (21.8 cm)  
with Bracket 10.7"<sup>±</sup> (27.9 cm)

**Depth:** 8.6" (21.8 cm)  
with Bracket 9.8" (24.9 cm)

**Weight:** FBO-10-DPL: 15 lbs  
FBO-14-DPL: 17 lbs

**Ports:** 1.5" NPT (Inlet and Outlet)

**Service Clearance (Drop-down):** 1.13" (2.87 cm)

**Maximum Pressure:** 150 psi (10.0 bar)

**Max Flow Rate:** 20 gpm (76 lpm) to 75 gpm (284 lpm)  
based on housing, fuel type and element.

**Fuel Type:** Diesel (up to B20), Gasoline, or Kerosene

\*\* Filter elements ordered separately unless noted

## Create a Part Number

Housing Type	Housing Size		Optional Add Ons			
	Required	10" Height **	14" Height **	Delta-P Gauge **	Delta-P Gauge/ Liquid Sight Glass **	25 micron Element Included
FBO	10	14	DP	DPL	25M	MA

ASSEMBLY	DESCRIPTION
FBO-10	10" Assy., Drain Valve
FBO-10-DP	10" Assy., Drain Valve, Delta-P Gauge
FBO-10-DPL	10" Assy., Drain Valve, Delta-P Gauge, Sight Glass
FBO-10-25M	10" Assy., Drain Valve, Delta-P Gauge, Sight Glass, 25 micron filter
FBO-10-MA	10" Assy., Marine - Drain Valve, Delta-P Gauge, Sight Glass, Bracket/Fittings, 25 micron filter
FBO-14	14" Assy., Drain Valve
FBO-14-DP	14" Assy., Drain Valve, Delta-P Gauge
FBO-14-DPL	14" Assy., Drain Valve, Delta-P Gauge, Sight Glass
FBO-14-25M	14" Assy., Drain Valve, Delta-P Gauge, Sight Glass, 25 micron filter
FBO-14-MA	14" Assy., Marine - Drain Valve, Delta-P Gauge, Sight Glass, Bracket/Fittings, 25 micron filter

## Dimensions:

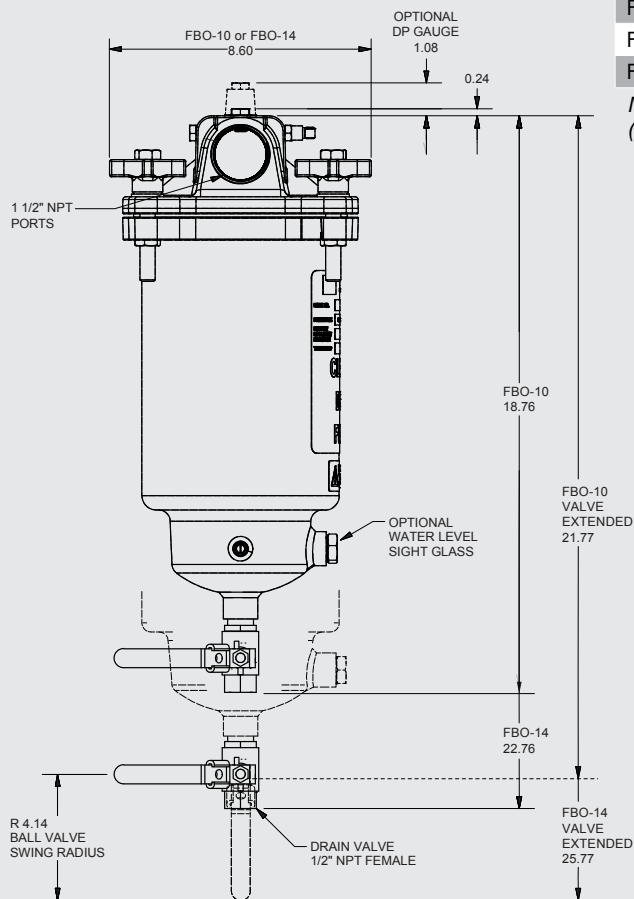

## Mounting Bracket Hole Pattern (Standard on Marine Unit)

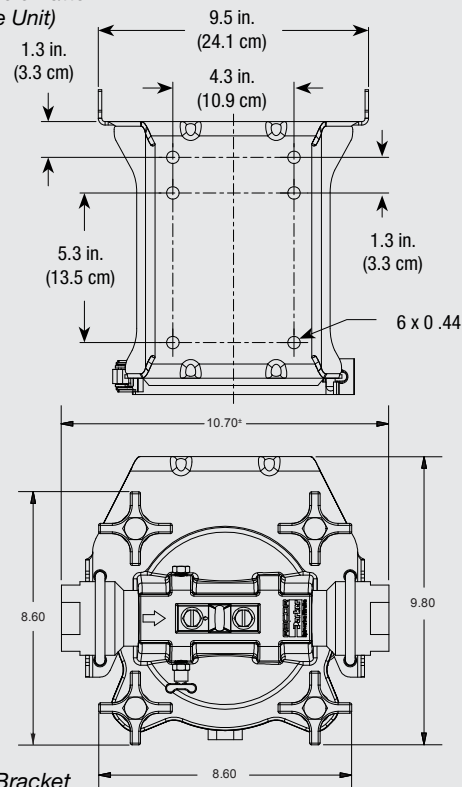

Top - with Bracket



# PARTS

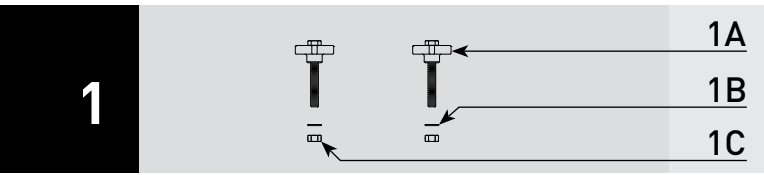

Part #	Description
<b>1A</b>	<b>72712</b> FBO 1/2" Knob Handle Bolt
<b>1B</b>	<b>71328</b> FBO 1/2" Washer
<b>1C</b>	<b>71329</b> FBO 1/2" Hex Nut

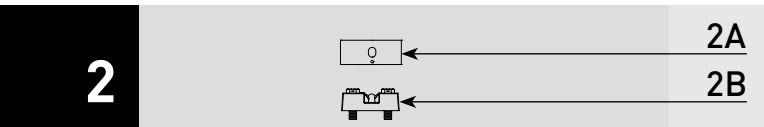

<b>2A</b>	DP Gauge Heat Shield (included in Marine Assembly)
<b>2B</b>	<b>72694</b> Differential Pressure Gauge (0-15 PSID)
	<b>72783</b> Differential Pressure Gauge (0-30 PSID)

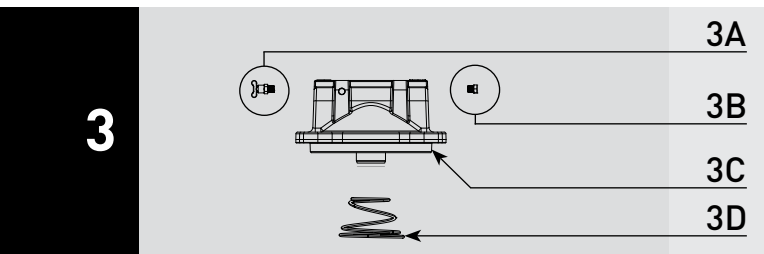

<b>3A</b>	<b>72695</b> 1/8" NPT Brass Vent Valve
<b>3B</b>	1/8" NPT Brass Pipe Plug
<b>3C</b>	<b>72531</b> FBO Head (Yellow)
	<b>73152</b> FBO Head (White)
<b>3D</b>	<b>72368</b> FBO Conical Spring - Stainless Steel

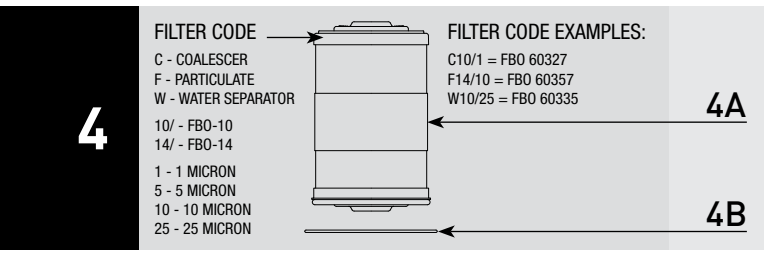

4A	FBO-10 Replacement Elements Includes 4B	Micron	Coalescer/Separator <b>C</b>	Particulate <b>F</b>	Water Absorber <b>W</b>
10/	1	FBO 60327	FBO 60330	FBO 60333	
	5	FBO 60328	FBO 60331	FBO 60334	
	10	FBO 60353	FBO 60354	FBO 60355	
	25	FBO 60329	FBO 60332	FBO 60335	
4A	FBO-14 Replacement Elements Includes 4B	Micron	Coalescer/Separator <b>C</b>	Particulate <b>F</b>	Water Absorber <b>W</b>
14/	1	FBO 60336	FBO 60339	FBO 60342	
	5	FBO 60337	FBO 60340	FBO 60343	
	10	FBO 60356	FBO 60357	FBO 60358	
	25	FBO 60338	FBO 60341	FBO 60344	
<b>4B</b>	<b>OV-13</b>	FBO Viton® O-ring			

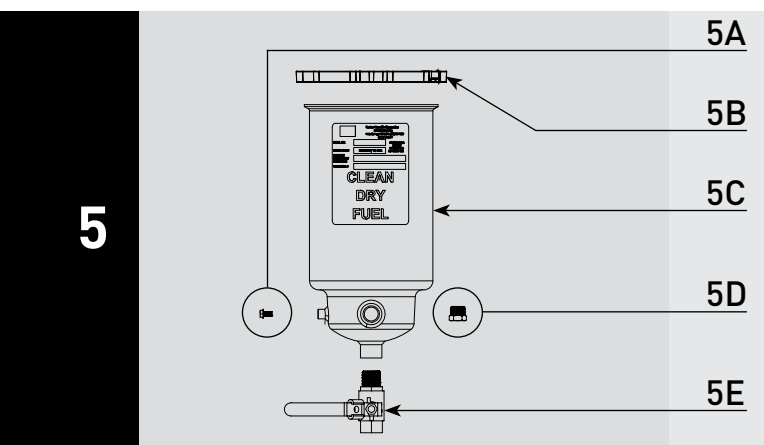

<b>5A</b>	Ground Screw - #10-32 X 3/8 Slotted Hex Head
<b>5B</b>	<b>72532-Y-KIT</b> FBO Flange (Yellow) - Includes 4B
	<b>73153-W-KIT</b> FBO Flange (White) - Includes 4B
<b>5C</b>	<b>72609</b> FBO-10 Housing (Black)
	<b>72610</b> FBO-14 Housing (Black)
<b>5D</b>	<b>72710</b> 1/2" NPT Brass Sight Glass
<b>5E</b>	<b>73225-.5</b> 1/2" NPT Brass Locking Ball Valve

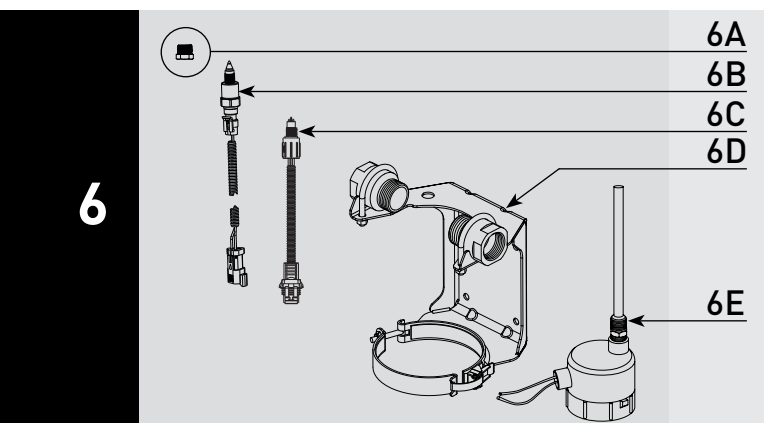

<b>6A</b>	<b>RK18-1656</b> 1/2" NPT Steel Adapter
<b>6B</b>	<b>RK23191-01</b> Steel - 1/2"-20 Water Sensor - Requires 6A
<b>6C</b>	<b>RK30880E</b> Plastic - 1/2"-20 Water Sensor - Requires 6A
<b>6D</b>	<b>73084</b> FBO Mounting Bracket Kit (Black) with Brass Fittings
<b>6E</b>	<b>FBO-HTR-KIT</b> 45 watt, 120 VAC Heater